

ARCH422 DESIGN STUDIO VI

건축설계 6 / 4학년 2학기

Studio Introduction

Studios & Instructors

Followings are this year's studios and their topics.

Studio 1

**Rethinking
Urban Street**

Gunwon Lee / 이건원
Taek Hong / 홍택



Studio 2

Meta Valley, Seoul

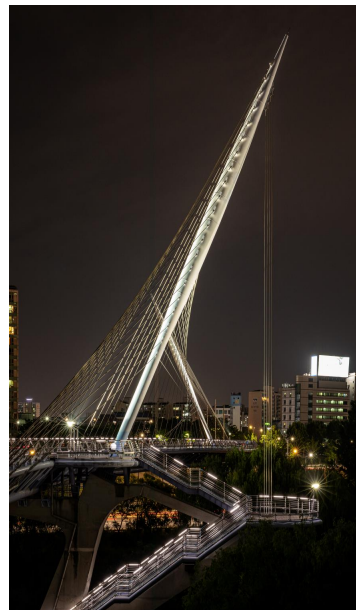
Daniel Oh / 다니엘오



Studio 3

**Bridging the Gap:
Rethinking the Relationship
of Architect & Engineer**

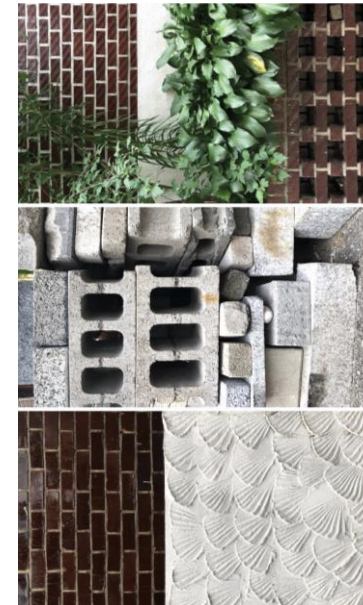
Sunwoo Park / 박선우



Studio 4

2023' Project School

Jeeseon Lim / 임지선



Studio 5

Green Tourism Resort

Jae-woo Lee / 이재우



Studio 1

Rethinking

Urban Street

Instructors

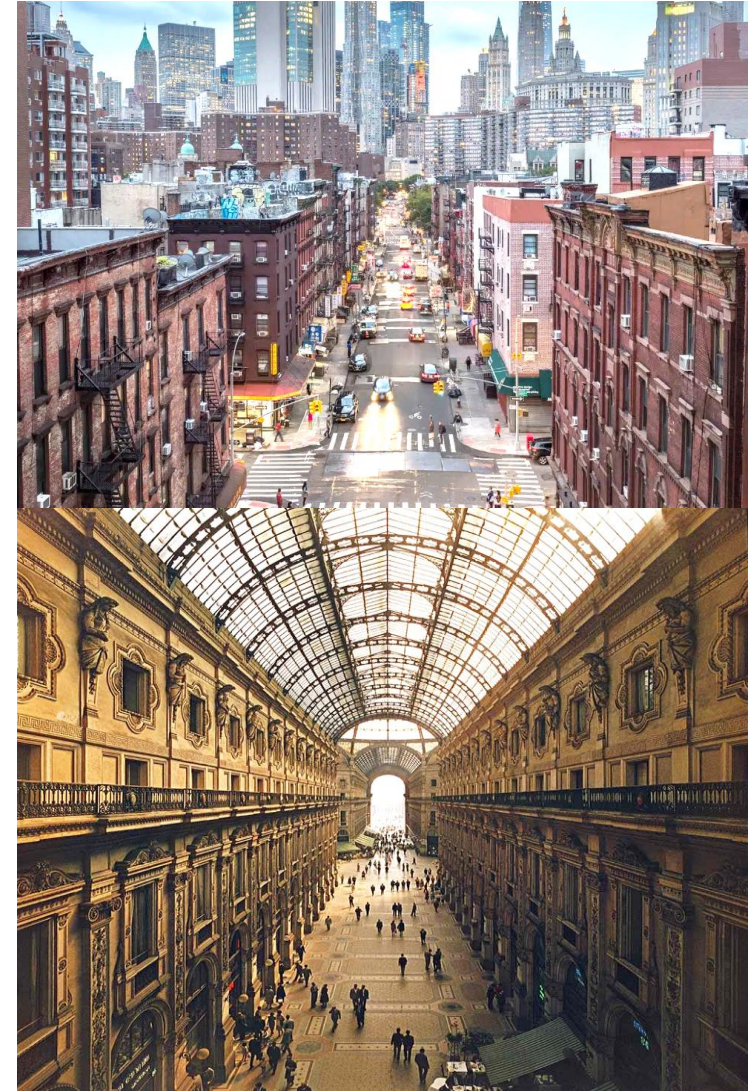
Gunwon Lee (이건원), Taek Hong (홍택)

Studio 1 Introduction

Rethinking Urban Street

Introduction of the Course

- **Course Outline:** This course is aimed at 4th grade students to analyze and understand the problems of the urban and the context of the city in order to proceed with architectural design, and based on this, to learn the overall process of planning and planning appropriate urban architecture programs and alternatives.
- **강의 개요:** 본 강의는 4학년 학생들을 대상으로 건축설계 진행을 위해서 도시의 문제, 도시의 맥락을 분석·이해하고 이를 바탕으로 적절한 도시건축 프로그램 및 대안을 기획 및 계획하는 전반적인 과정을 익히고자 한다.
- **What is 'Urban Design'?:** It is also true that it is difficult to grasp the reality of urban design as it has various aspects to suit the purpose of its birth. However, it is clear that urban design has its roots in architectural design, is located at the planning design stage of architectural design or just before it, and is an area of constant contemplation to prepare alternatives as a better built environment. In other words, one aspect of urban design is the starting point of architectural design and its role as an intermediate connector between city and architecture.
- **‘도시설계’란?:** 도시설계는 그것의 탄생 목적에 맞게 다양한 모습을 지니고 있어 그 실제 파악이 어려운 것도 사실이다. 하지만 분명 도시설계는 건축설계에 그 뿌리를 두고 있고, 건축설계의 기획설계 단계 또는 그 바로 앞 단계에 위치하며, 더 나은 건조환경으로서의 대안을 마련하고자 끊임없이 고민하는 영역이다. 즉, 건축설계의 시작점이자 도시와 건축의 중간 연결자로서의 역할이 도시설계의 한 가지 모습인 것이다.

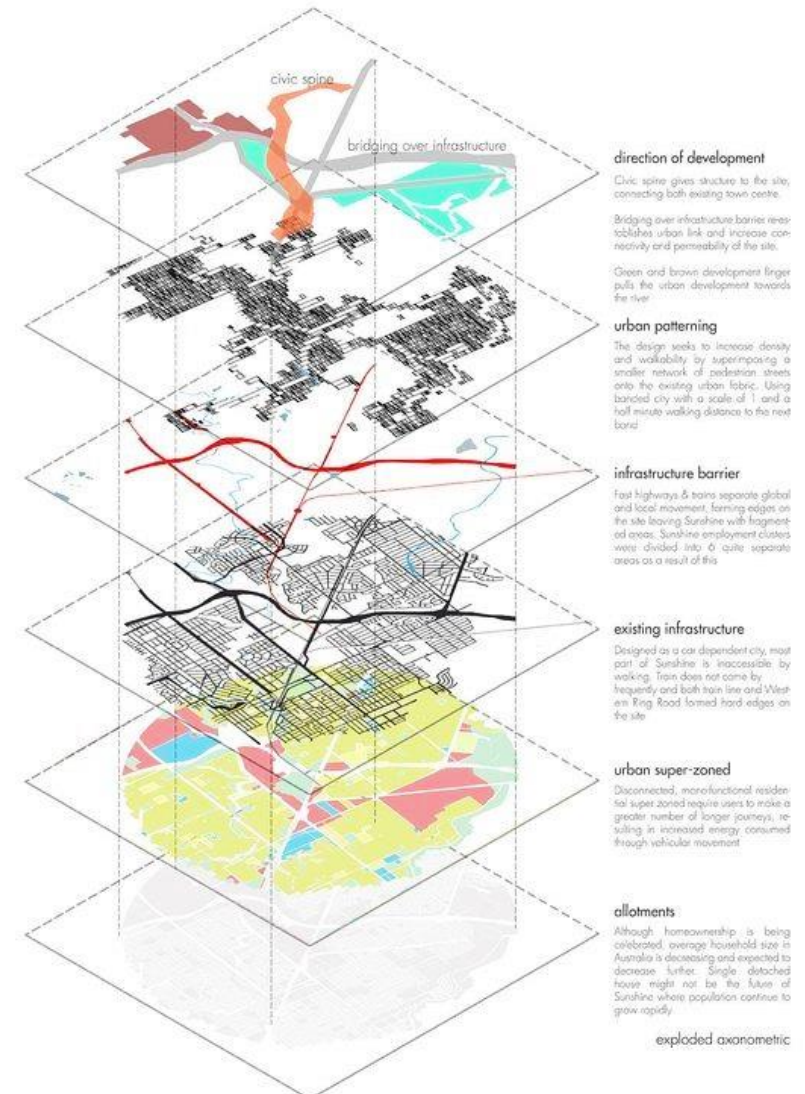


Studio 1 Introduction

Introduction of the Course

- **Objective of the Course:** In this studio, students will analyze the given urban context and problems by integrating the knowledge related to architecture and cities they have learned so far. Then, based on this, after deriving appropriate urban and architectural concepts and appropriate programs, students will ultimately derive their own architectural design based on their own architectural solutions and vocabulary. In other words, as an 'architect', it aims to cultivate a series of processes to derive its own unique architectural alternative, starting from the consideration and interpretation of the city of the present age in which it lives. It is expected that the knowledge and experience that students will gain through this studio will become the basis for the next semester's graduation design.
- **강의 목표:** 본 스튜디오의 학생들은 그동안 배운 건축, 도시와 관련된 지식을 통합적으로 활용하여, 주어진 도시 맥락과 문제점을 분석하게 될 것이다. 그 후, 이를 바탕으로 그에 걸맞는 도시 · 건축적 개념과 적절한 프로그램을 도출한 후, 최종적으로는 자신만의 건축적 해법과 어휘를 바탕으로 자신만의 건축설계를 도출하게 될 것이다. 즉, 한 명의 'Architect'로서 자신이 살고 있는 현시대의 도시에 대한 고민과 해석에서 출발하여, 자신의 독특한 건축적 대안을 도출하는 일련의 프로세스 함양을 목적으로 하고 있다. 이 스튜디오를 통해 학생들이 얻게 되는 지식과 경험은 다음 학기의 졸업설계를 위한 근간이 될 것으로 기대된다.

Rethinking Urban Street



Studio 1 History

History of Moonbae Business District

- The site is located in the area about 20,000m² of 57-6 Wonhyo-ro 1-ga, Yongsan-gu, Seoul, and is designated as ②-1, ②-2, and ②-3 districts among the special planning zones of Yongsan Munbae Business District.

- 대상지는 서울특별시 용산구 원효로1가 57-6 일대에 소재한 약 20,000m² 규모의 대지로, 용산 문배업무지구 특별계획구역 중 ②-1, ②-2, ②-3 지구로 지정된 지역이다.

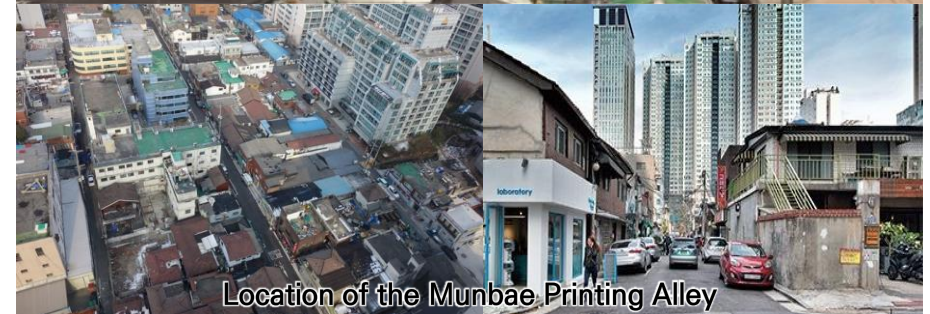
- During the Japanese Colonial Era, Wonhyo-ro, Hangang-ro, Munbae-dong, and Singye-dong near the site were the areas where the most Japanese lived in Yongsan. Even today, there are still many 'Enemy's House(적산가옥)' with steep gabled roofs in the area of the site.

- 일제강점기 시절, 대상지 인근의 원효로 1~4가, 한강로 1~3가, 문배동, 신계동 등은 용산 내에서 일본인이 가장 많이 거주하는 지역이었다. 현재까지도 대상지 일대에는 가파른 맞배지붕을 가진 '적산가옥'이 다수 존재한다.

- After liberation, until the 1960s, the site seemed to revive for a while as a printing alley with dense printing shops. However, it declined with the decline of the domestic printing and publishing industry due to the development of computer technology, from the 1970s to the 1990s.

- 해방 이후 1960년대까지 인쇄소가 밀집한 인쇄골목으로 잠깐 부흥하는 듯 싶었으나, 1970~1990년대 컴퓨터 기술의 발전 및 국내 인쇄·출판 산업의 쇠락과 함께 쇠퇴하게 되었다.

Rethinking Urban Street



Studio 1 History

History of Moonbae Business District

- The development of the Yongsan Munbae business district was promoted, but it was canceled due to the opposition of residents and remained in a declining area. Afterwards, an alley called “Island of Passion(열정도)” was formed by local young people centered on self-employed people.

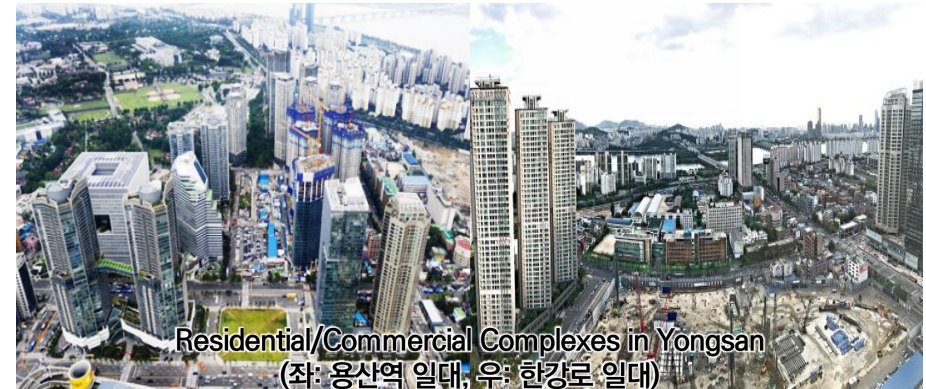
- 용산 문배업무지구 개발이 추진되었으나 주민의 반대로 무산되고 쇠퇴한 지역으로 남았다.

이후 자영업자 중심의 지역 청년들에 의해 ‘열정도’라는 이름의 골목상권을 형성했다.

- However, except for this area, residential/commercial complexes or business facilities have already been developed in the surrounding area, and the Namyong Station of Line 1, the Samgakji Station of Line 4/6, and the Hyochang Park Station of Line 6 and Gyeongui-Jungang Line are all located 5 to 10 minutes on foot, so it is also an area with considerable development pressure. Munbae business district special planning district ②-3 district is already being demolished.

- 하지만 이 일대를 제외하고는 이미 그 주변 일대는 주상복합시설 또는 업무시설이 개발이 되었고, 1호선 남영역, 4/6호선 삼각지역, 6호선 및 경의중앙선의 효창공원역이 모두 도보로 5~10분 거리에 위치하고 있어 상당한 개발압력이 존재하는 지역이기도 하다. 문배업무지구 특별계획구역 ②-3지구는 이미 철거가 진행되고 있기도 하다.

Rethinking Urban Street



Studio 1 Site

Hyochang Park

Cheongpa-dong

Rethinking Urban Street

Namyeong-dong

Military Facility

Hyochang-dong

Moonbae Business District
Special Planning Zone No. 2-1~3

- Address: 57-6, Wonhyo-ro 1 ga, Yongsan-gu, Seoul
- Total Area: 20,600m²

SITE

Moonbae Business District
Special Planning Zone

Namyeong
Station

250m

500m

750m

1km

Subway
Airport Line

Hyochang Park
Station

Yongsan
District Unit Plan Area

Subway Gyeongui-
Jungang Line

Subway
Line No.1

Subway
Line No.1

Sangakji
Station

Subway
Line No.4

War Memorial
of Korea

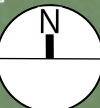
Yongsan International
Business District

Yongsan
Electronics Market

Hangang-ro-
dong

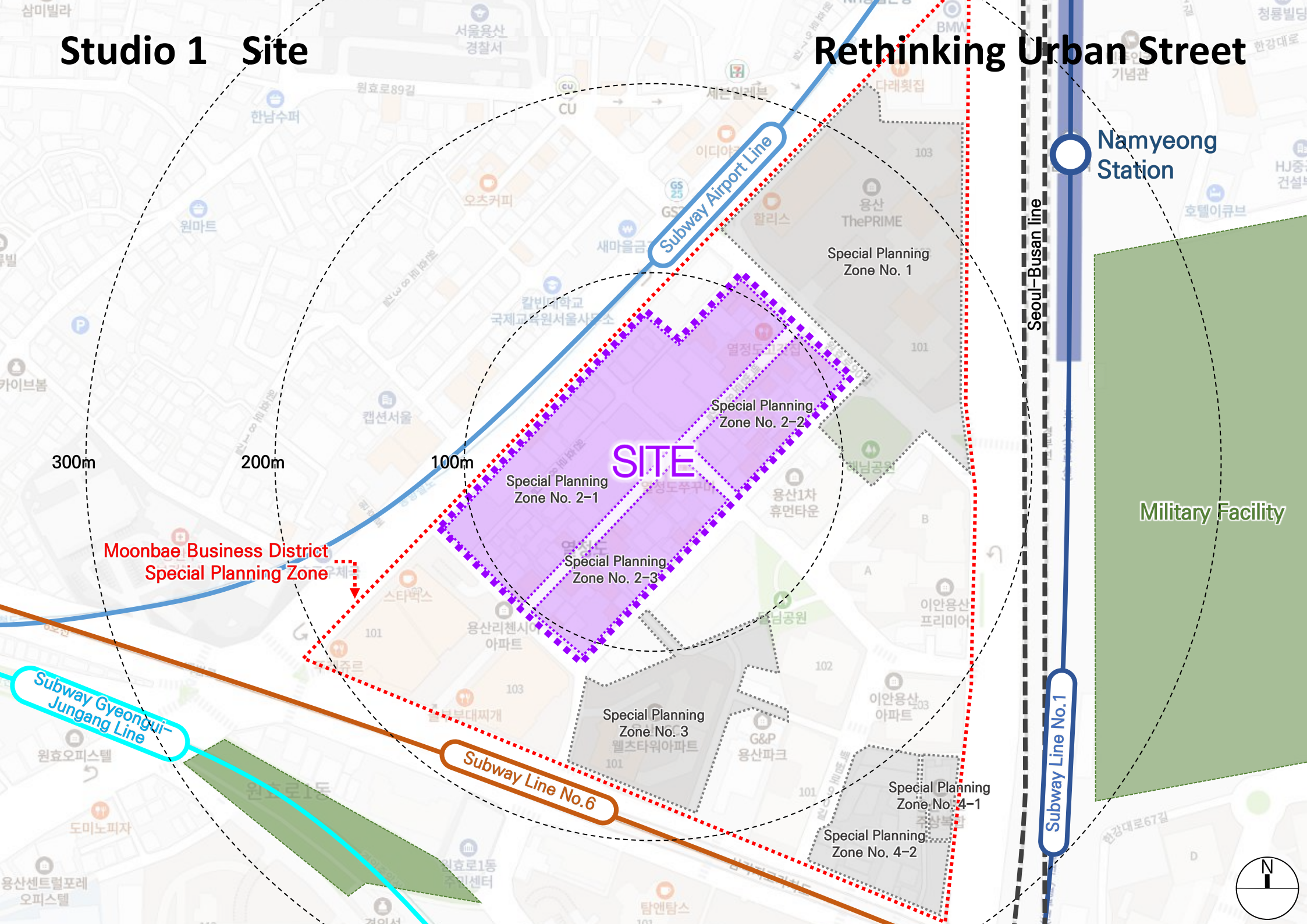
Office of the President
Republic of Korea

Yongsan Park



Studio 1 Site

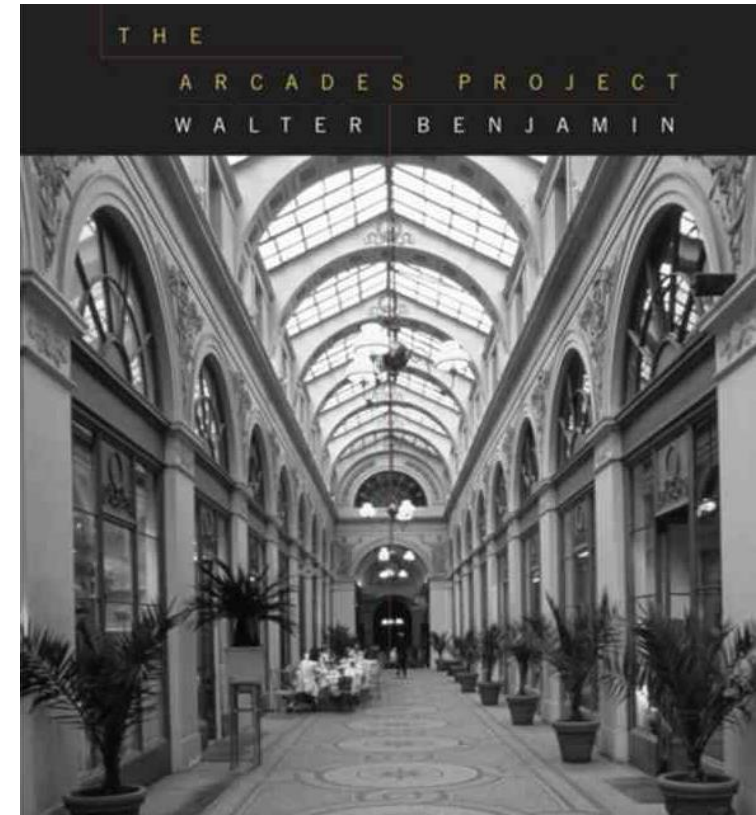
Rethinking Urban Street



Studio 1 Topic

Rethinking Urban Street

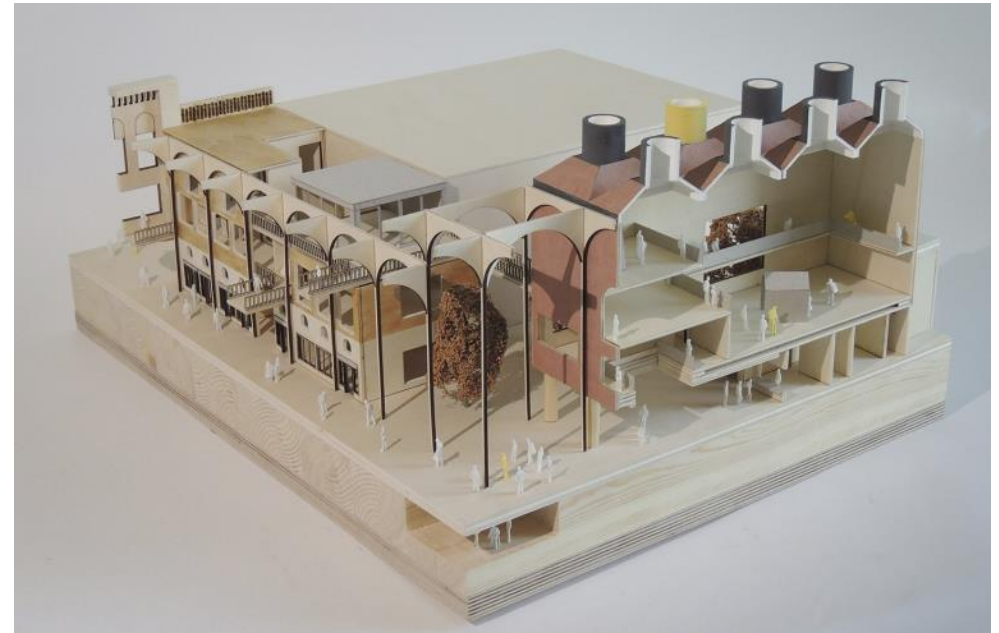
Rethinking Urban Street and Arcade



Studio 1 Topic

Rethinking Urban Street

Rethinking Urban Street and Arcade





Gunwon Lee / 이건원

Ph.D. in Urban planning and design (Korea University)
Master in Architectural planning (Korea University)

Associate Professor(Hoseo University)
Lecturer and Assistant Professor(Mokwon University)
SAC International, Ltd.



Taek Hong / 홍택

Master of Architecture (Japan)
한국 건축사 (KIRA)

www.systemlabgroup.com

Studio 2

Meta Valley, Seoul

Instructor

Daniel Oh

Studio 2 Site



Meta Valley, Seoul

Studio 2 Site



Meta Valley, Seoul



Studio 2 Introduction

Meta Valley, Seoul

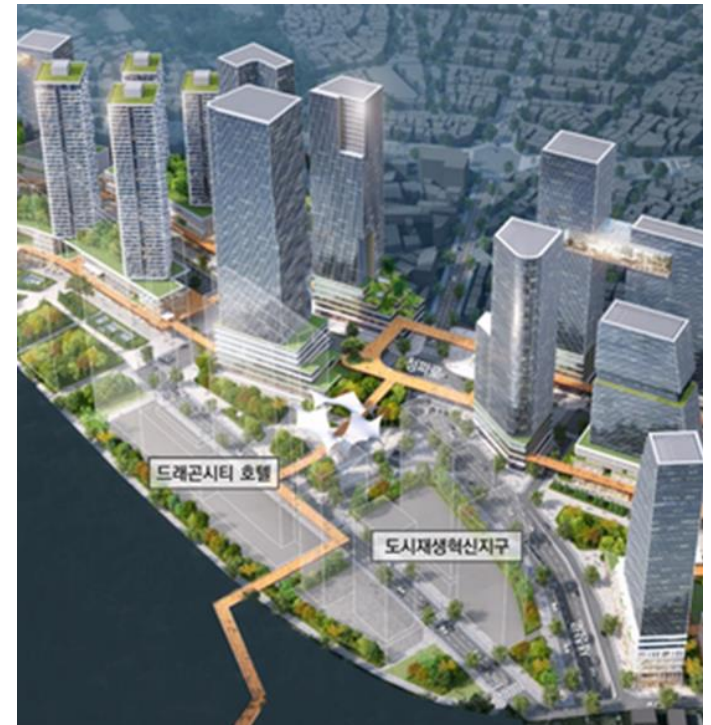
YONGSAN ELECTRONICS MARKET

- Yongsan Electronics Market is once the most prosperous and most visited place in Seoul that catapulted the computer and electronics industry of South Korea in the 1980's. It was the wholesale and retail sector of high-tech which allowed consumers to have access to high-tech. However, due to the internet and online commerce, the downfall of the district came as quick as its rapid growth. Having the right physical location is no longer prerequisite for the 21st century urban development while the digital transformation taking place in urban infrastructure that questions the very essence of our physical urban environment. How shall architects and urban designers provide the vision for the future city?



META VALLEY, SEOUL

- The studio aims to combine several programmatic elements into architecture that is open to the public yet provides feasibility as an economically viable urban development. Around the world many attempts have been made to connect different places using green space while supplying economic benefits to provide certainty to ROI and operation.
- Identifying industry will be the first part of the task. How do you define innovation district when all the high-tech industries are already located somewhere else in Seoul and near Seoul. We should avoid creating competition as this disrupts the existing ecosystems. This is a crucial element of the project where each student must balance the design with economic sensibility. The studio challenges to integrate green infrastructure and architectural approach to link and provide access to the public.



Studio 2 Objectives

RETHINKING CITIES AS DIGITAL PLATFORMS

- The STUDIO will be looking at the digital infrastructure to provide a “future-ready” district for the future city. With the Digital Transition, more and more experts are seeing cities as digital platforms. In 2023, SMG announced Seoul as the first Metaverse city. It’s still at an early stage of development, but the opportunities and promises are attracting attention from all over the world. How can we understand and build a city as a platform? And how can architects harness the power of architecture to connect and create synergy between online and offline worlds?

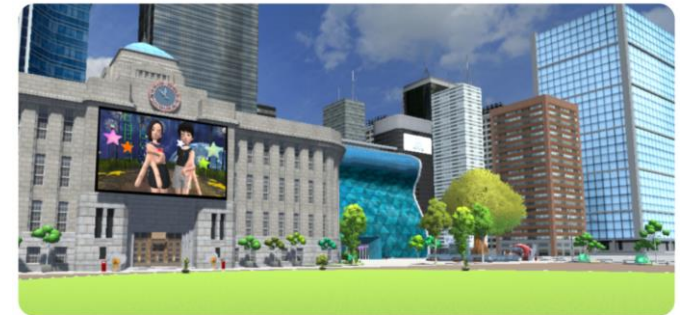
BRINGING INNOVATION TO INNOVATION DISTRICTS

- The studio aims to combine several programmatic elements into architecture that is open to the public yet provides feasibility as an economically viable urban development. Around the world many attempts have been made to connect different places using green space while supplying economic benefits to provide certainty to ROI and operation.
- Identifying industry will be the first part of the task. How do you define innovation district when all the high-tech industries are already located somewhere else in Seoul and near Seoul. We should avoid creating competition as this disrupts the existing ecosystems. This is a crucial element of the project where each student must balance the design with economic sensibility. The studio challenges to integrate green infrastructure and architectural approach to link and provide access to the public.

Meta Valley, Seoul

Metaverse Seoul

The space where I meet another me,
The New Continent of Seoul 'Metaverse Seoul'



INNOVATION DISTRICTS AROUND THE WORLD



Jurong Innovation District (JID) is a 600-hectare District covering the Nanyang Technological University, JTC's CleanTech Park, as well as the Bulim, Bahar and Tengah areas. The District will play host to an advanced manufacturing campus, factories of the future and companies at the forefront of key growth sectors such as advanced manufacturing, urban solutions and smart logistics.



South Lake Union's evolution as a hub for innovation required consistent collaboration between elected officials, advocates and the business community. From transportation solutions to power grid improvements, the neighborhood needed major upgrades, necessitating both public and private action. Thus, collaboration and trust between these sectors became essential to SLU's transformation.

INNOVATION DISTRICTS AROUND THE WORLD



BLOXHUB is a hub that develops sustainable development solutions with a co-working space in the heart of Copenhagen and an international network, consisting of companies, organizations and researchers within urban areas. Over the next 30 years, it is expected that the urban world population will be doubled. BLOXHUB is founded with a starting point and, at the future solutions, it requires long close cooperation between architecture, tech, building and construction.



Sangam Digital Media City (DMC) was created as part of the larger Millennium City project in the Sangam-dong district of Seoul, 4 miles (7 km) from the central business district. Conceived as an industrial cluster of world-class digital media and entertainment companies, it now develops, produces and disseminates cutting-edge media contents – where the environment and technology, culture and industry, investment and innovation, converge and blend in a successful way.

INNOVATION DISTRICTS AROUND THE WORLD



King's Cross Central (KXC) is a multi-billion pound mixed-use development in the north-east of central London.[citation needed] The site is owned and controlled by the King's Cross Central Limited Partnership. It consists of approximately 67 acres (27 ha) of former railway lands to the north of King's Cross and St Pancras mainline railway stations.



22@District, the Ajuntament de Barcelona, a society of the Barcelona a City Council, asked a question: What measures can be taken to improve and increase the interactions between the international community and the local firms and institutions in Barcelona? The answers would eventually become the 22@District. In 2000, 22@District began as a government initiative to transform the dilapidated historic cotton district of Sant Martí into a booming knowledge center.

LG BUSINESS RESEARCH (LG 경영연구원)

- This studio is one of the participating studios for Future City Program hosted by LG Business Research.
- The outcomes of the studio will be shared with other university researches in December.
- Field trips and other expenses will be sponsored by the Future City Program.
- <https://www.lgbr.co.kr/en/index.do>

IGIS ASSET MANAGEMENT (이지스 자산운용)

- The studio will be using one of the properties owned by IGIS Asset Management.
- Students will be exposed to real estate development and financial system of realizing urban developments.
- The studio will make presentations to the teams at IGIS and ULI Young Leaders Group.
- The studio is recommended to the students who are interested in getting jobs in property development and urban development sector.

URBAN DESIGN INSTITUTE OF KOREA (한국도시설계학회)

- The studio will be participating in a seminar series organized by UDIK on Future City Infrastructure.
- Students will be offered to engage with the experts and researchers
- Research will be published as a blog post or newsletter on UDIK website

FIELD TRIPS (TBD)

- Sangam DMC, Magok, Pangyo, etc.
- Busan Eco Delta City
- Danish Innovation Center



Daniel Oh

MUP, Harvard University
BA, Berkeley University

Associate Professor, Korea
University

American Institute of Certified
Planners (AICP, USA)

https://archi.korea.ac.kr/arch/about/faculty_professors/

Studio 3

Bridging the Gap:

Rethinking the Relationship of Architect and Engineer

Instructors

Sunwoo PARK(박 선우)

Studio 3



여의도 샛강다리

한국은 물론 세계 어디를 가도 엄청난 교량이 운용되고 있다.

도로, 건물, 강, 계곡 등등에 필요한 구조물이다.

한국에서 교량은 이제까지 토목분야의 영역으로만 생각해 왔다.

그러한 관계로 단지 두 지역을 연결하는 단순한 기능에만 충실하였다.

이러한 교량들은 무미건조한 공학적인면만 강조되었다.

그러나 세계적인 추세는 지역의 상징성이 추가된 하나의 예술적인 조형물로 건설되고 있다.

Studio 3



이번학기에는 차량을 위한 교량이 아닌, 공학+예술(tech+art)적인 면이 강조된 사람과 자전거를 위한 보행교(footbridge, pedestrian bridge)를 계획하고 설계해보고자 한다. 즉 하나의 조형물로서 보행교를 생각해 보려고 한다.

두 지역을 연결하는 것이다. 그러나 이러한 순수 기능을 이외에 그 지역을 상징하는 하나의 조형물로 계획될 수 있다. 보행교의 기본적인 구조형태는 힘이 1방향으로 작용하는 상당히 단순하다. 그러므로 힘의 복잡한 역학적인 지식이 필요없다. 대상부지의 선택은 다양하다. 고려대 교내에서 보행교가 필요한 부분, 중랑천, 한강 등등에서 각자가 타당하다고 생각하는 지역을 선정하여 진행될 것이다.



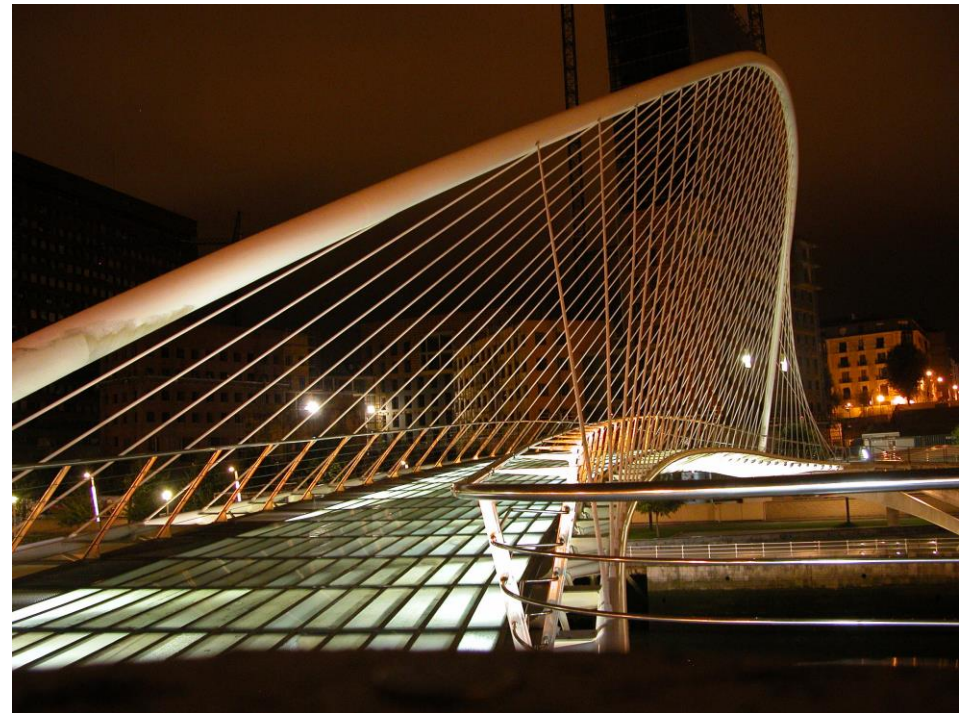
Studio 3



구조와 설계는 결코 만날 수 없는 평행을 유지하면서 결코 만날 수 없는 관계를 유지하고 있다. 이러한 문제점을 해결하기 위해 기술+예술(tech+art)이 서로 융합할 수 있는 것을 학습목표로 하고 있다.

학부에서 배운 기본적인 구조지식을 실제적으로 건축구조물에 적용하는 방법을 목표로 한다. 모든 주변 환경에 적절한 아름다운 구조시스템을 개발하고, 또한 실제적으로 접합이나, 기타 조건에 순응하는 디테일 해결방법을 이해하도록 한다.

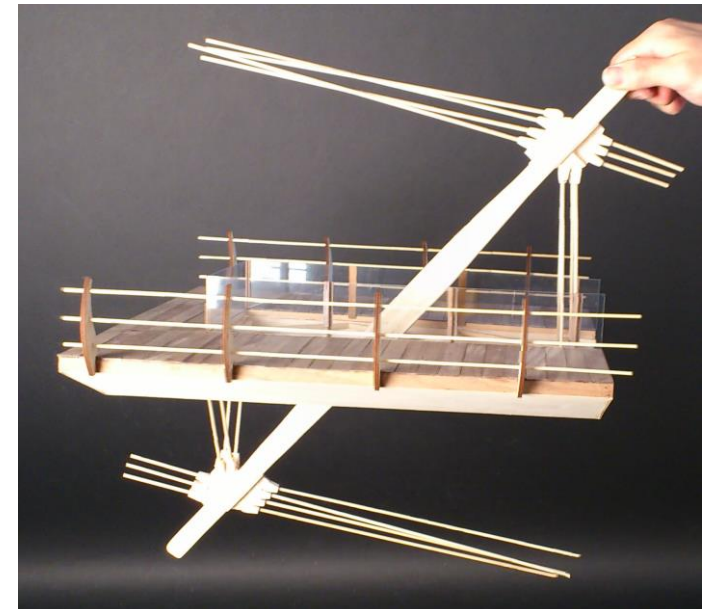
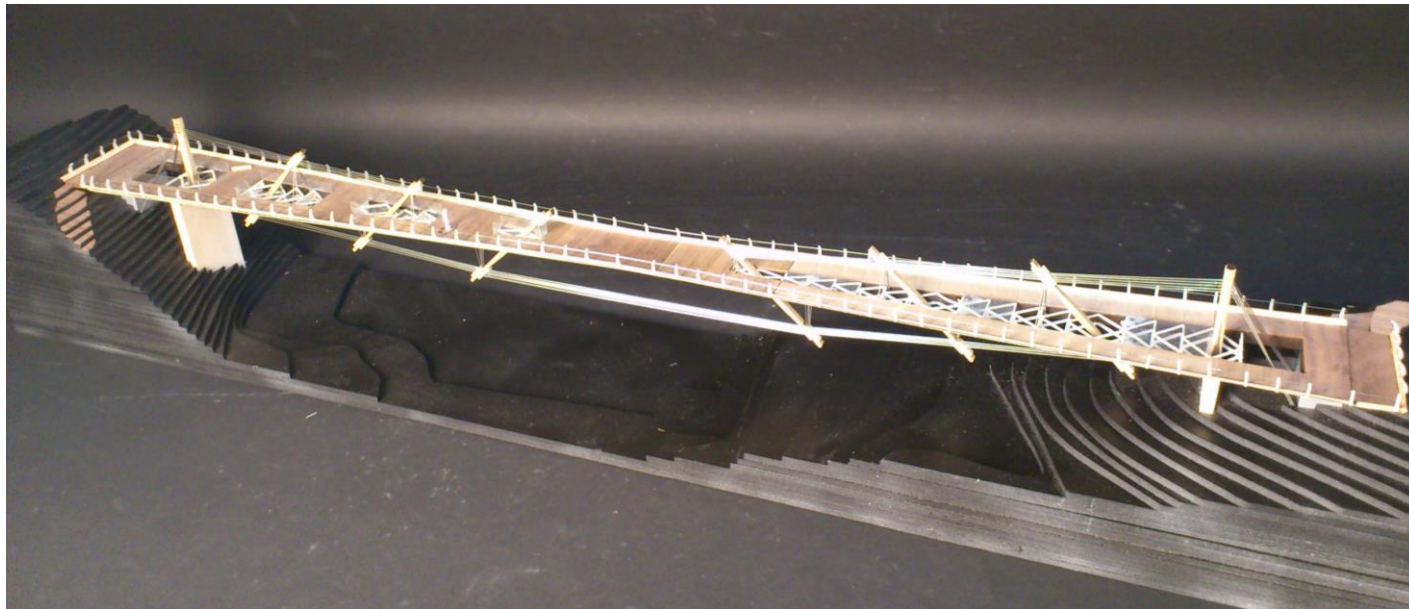
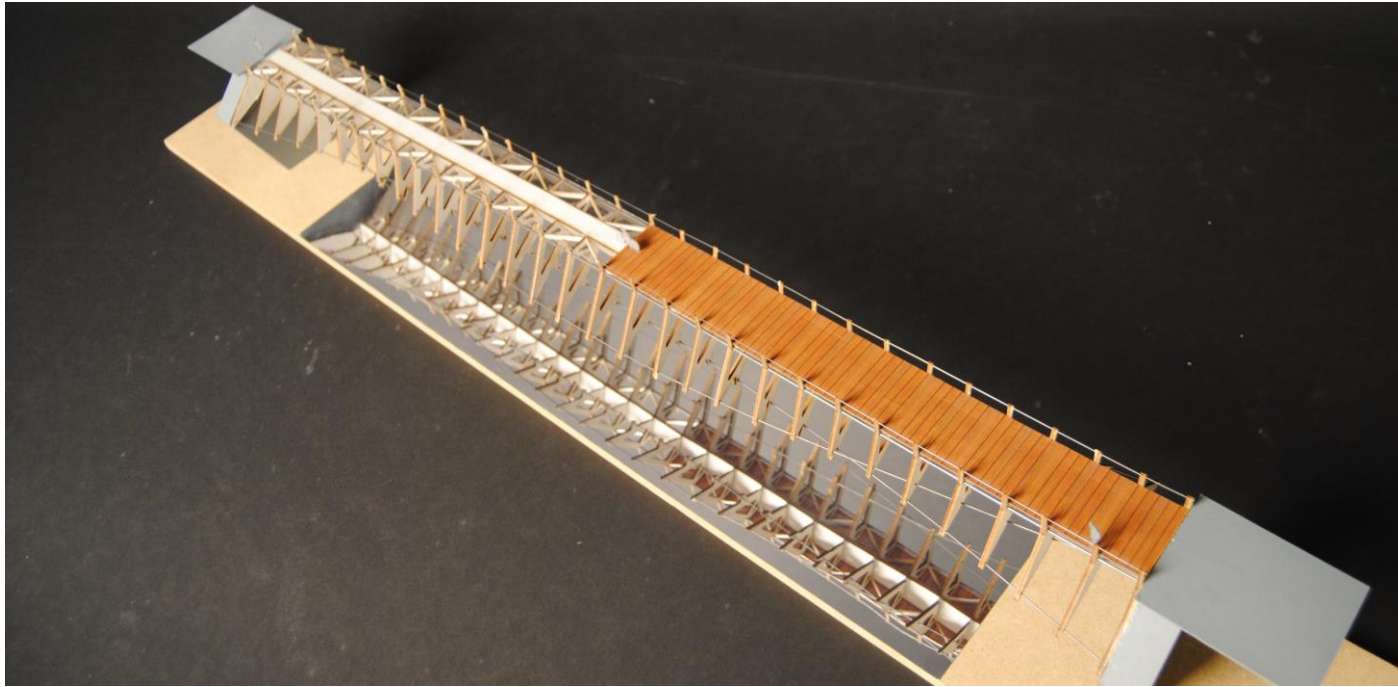
Studio 3



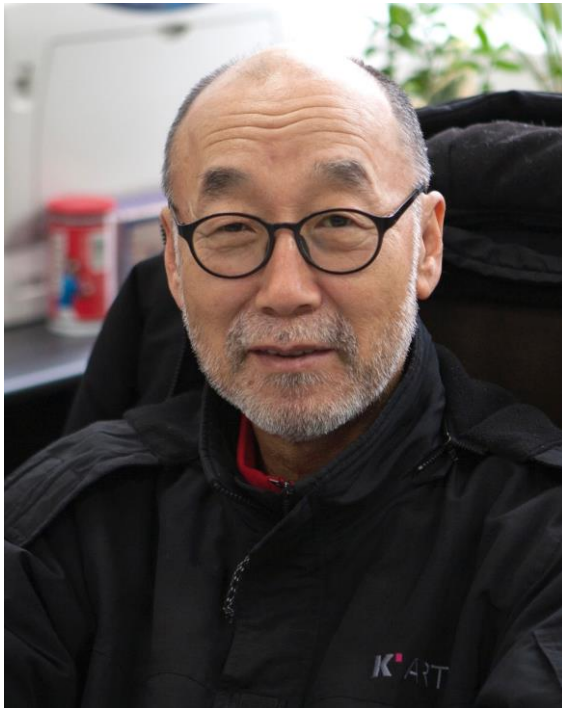
Studio 3



Studio 3



Studio 3



박선우 Sunwoo PARK

Korean Uni. Bachelor+ Master

RWTH-Aachen, Dipl.-Ing.

Uni. Dortmund, Dr.-Ing.

Uni. Stuttgart, Visiting Prof.

Emiritus Prof.

Korea National University of Art

Studio 4

2023'

Project School

Instructor

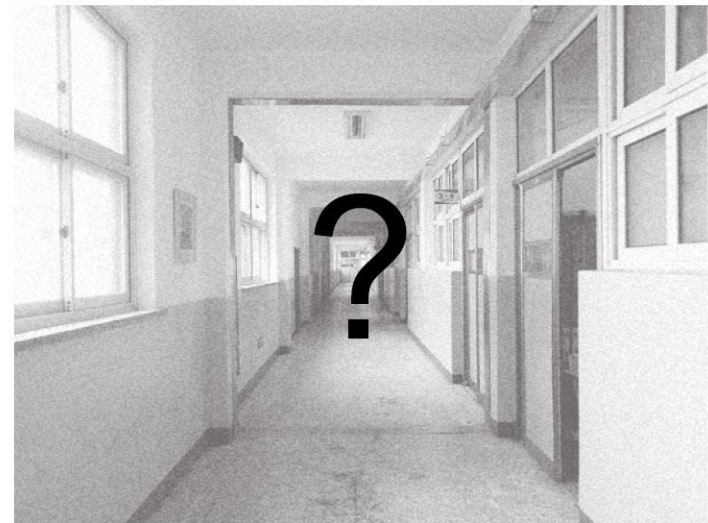
Jeeseon Lim | 임지선

School, Here and Now

A school is a public building in which everyone must spend the first part of their lives. Schools are also one of the most important community infrastructures.

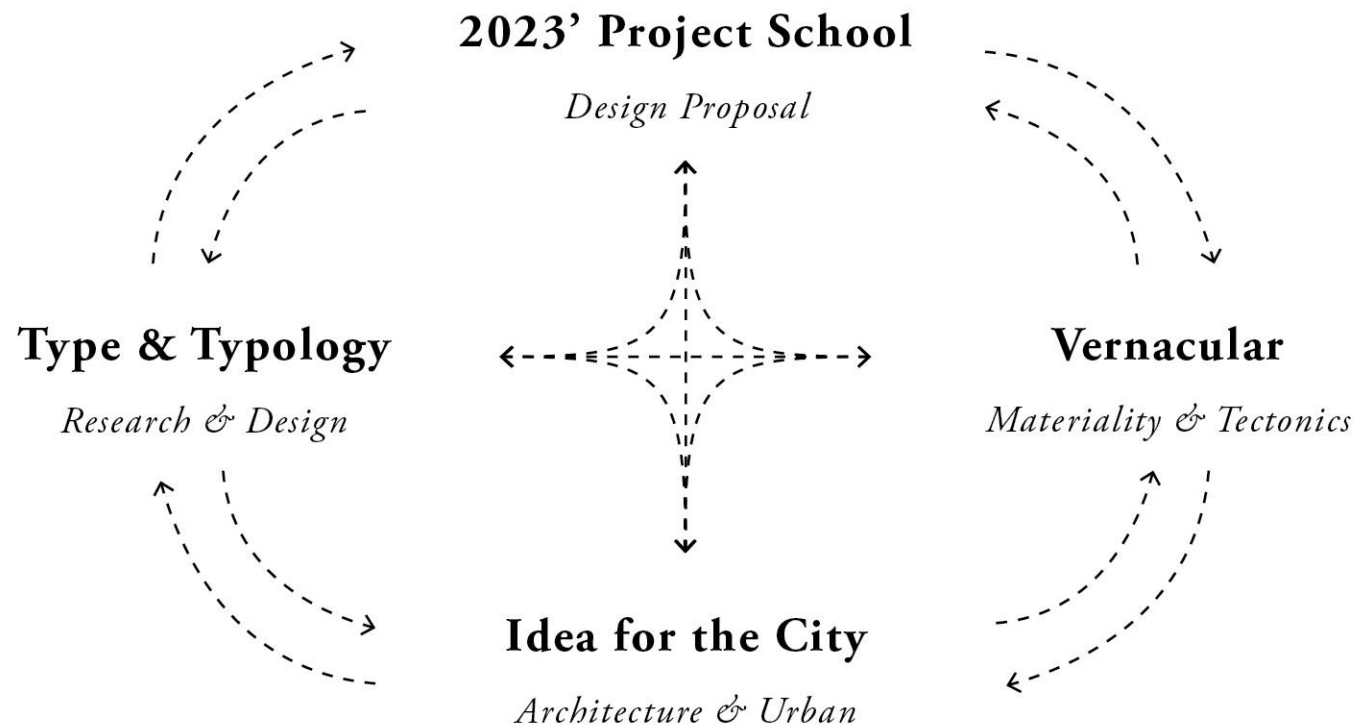
In South Korea, schools are being challenged more than ever by rapidly changing demographics. The architectural response to a series of pressing issues must be addressed on multiple levels.

Students are encouraged to enhance the functions of the school itself or to integrate with other programs based on urban, socio-cultural and environmental issues related to their project briefs.



The Themes

The design of a school will be structured around 2 themes, which are architectural 'Type & Typology' as a research / design tool and the concept of 'Vernacular' for materialization. The individual project will be concluded with his/her 'Idea for the City'.



Type & Typology

“To raise the question of typology in architecture
is
to raise a question of the nature of the architectural work itself.’

“What then is type?
It can most simply be defined as
a concept which describes a group of objects characterized by the same formal structure.
It is neither a spatial diagram nor the average of a serial list.
It is fundamentally based on
the possibility of grouping objects by certain inherent structural similarities”

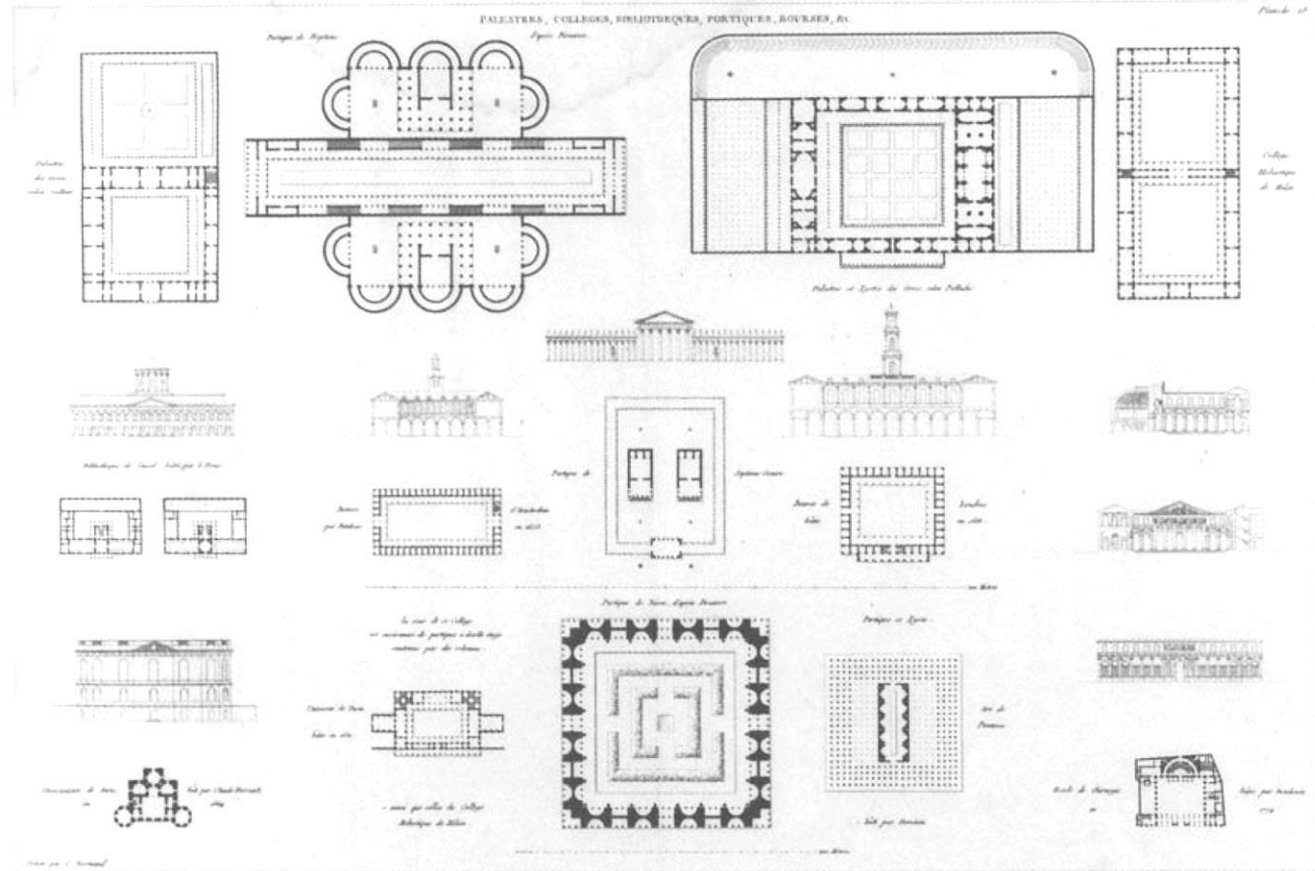
Rafael Moneo “On Typology” in Oppositions 1978

Collectiveness



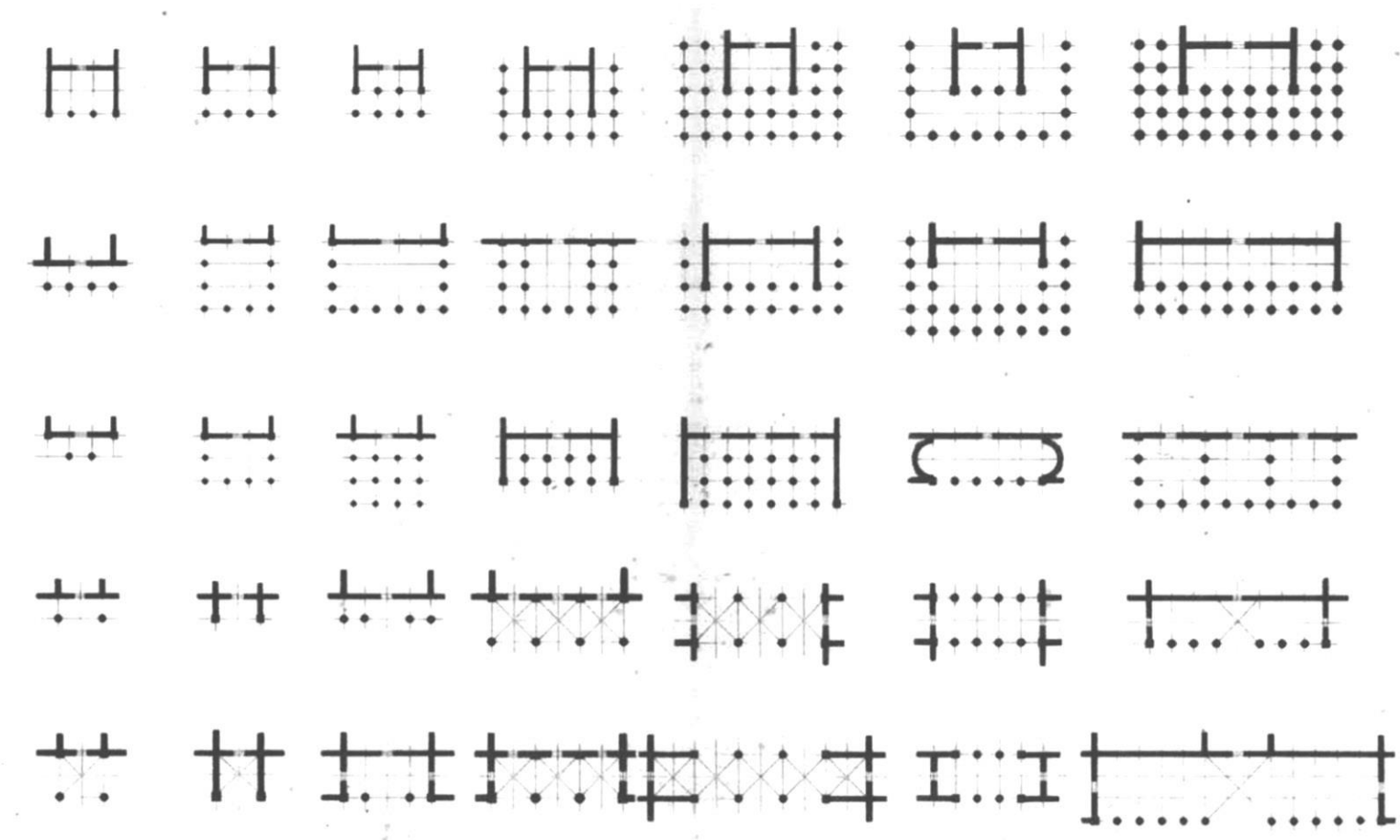
Framework Houses of the Siegen region of Germany
Bernd & Hilla Becher 1959-1973

Precedents & Classification



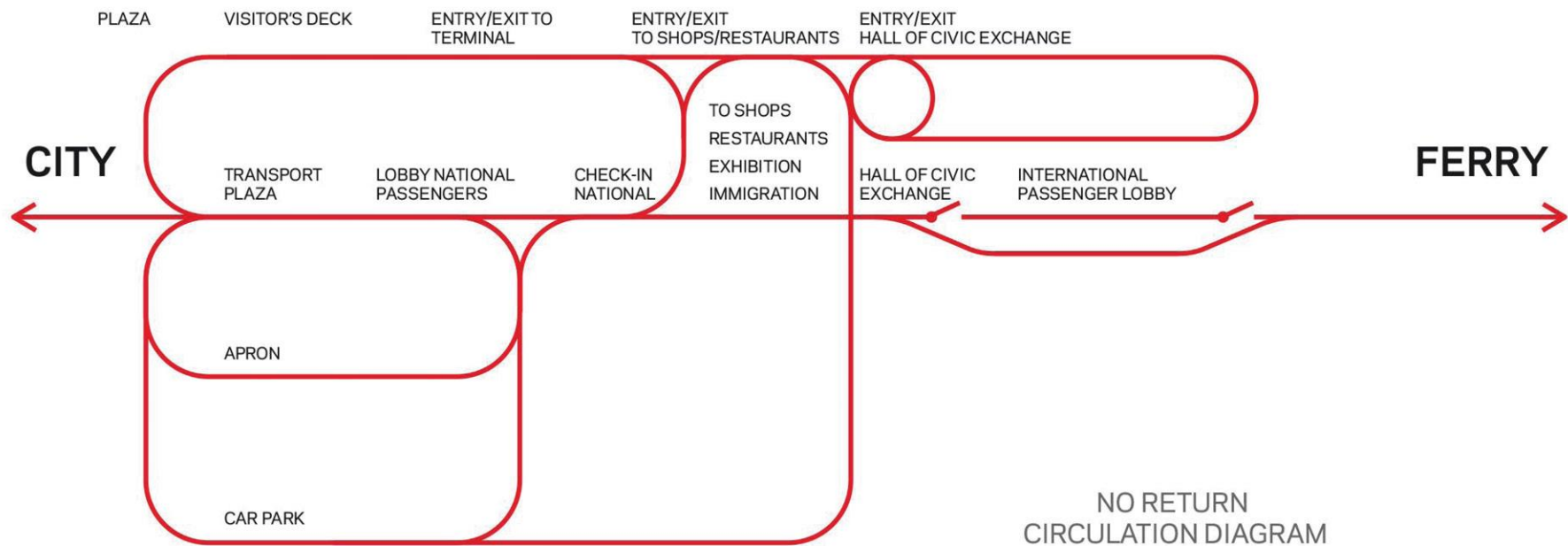
Gymnasia, Colleges, Libraries, Porticos, Commodity Exchanges, and so on
From Durand, *Recueil et parallèle des édifices de tout genre* 1800/1801

Abstraction



Plans for Porches, Jean-Nicolas-Louis Durand 1809

(Abstract) Diagrams

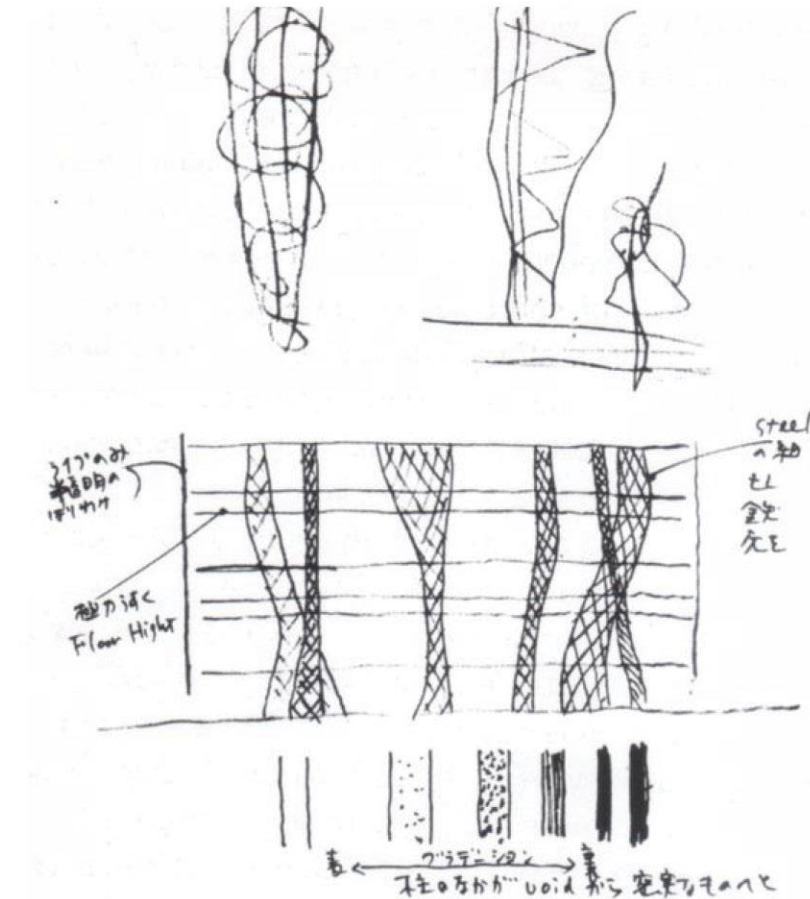


No Return Circulation Diagram
Yokohama International Port Terminal, Foreign Office Architects

(Abstract) Diagrams

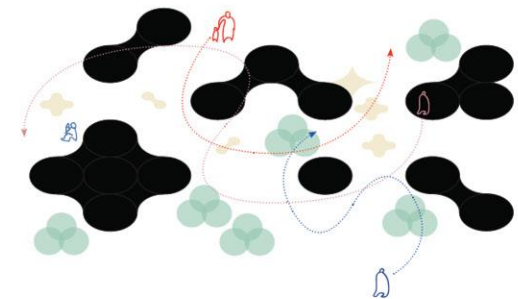
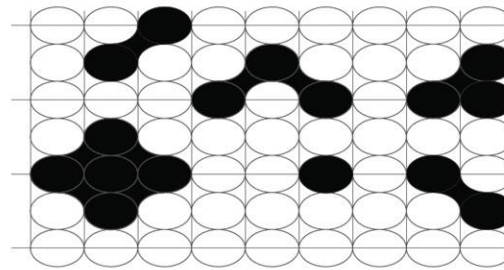
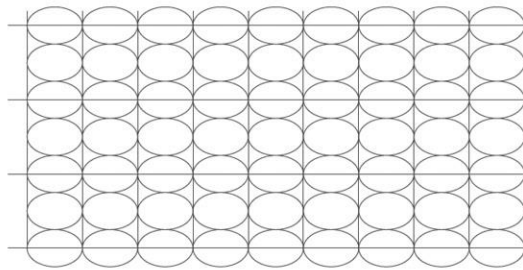
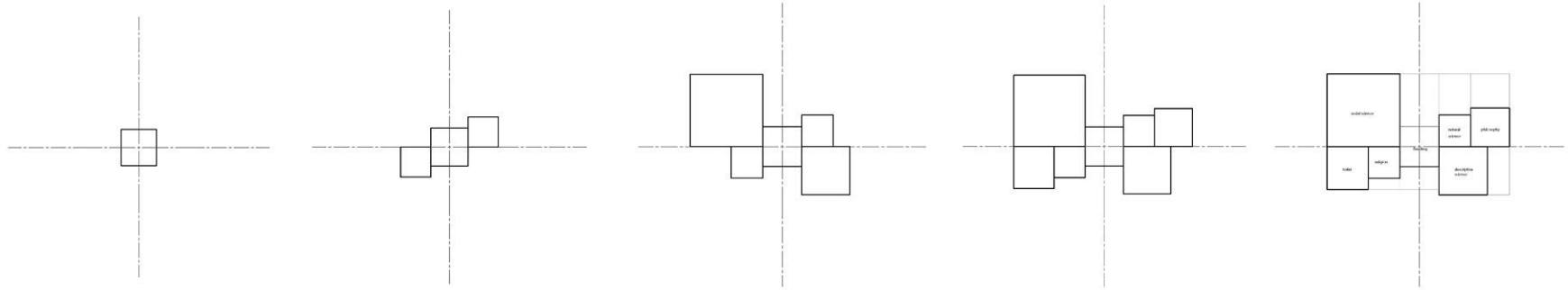


Diagram by OMA
Seattle Central Library, USA



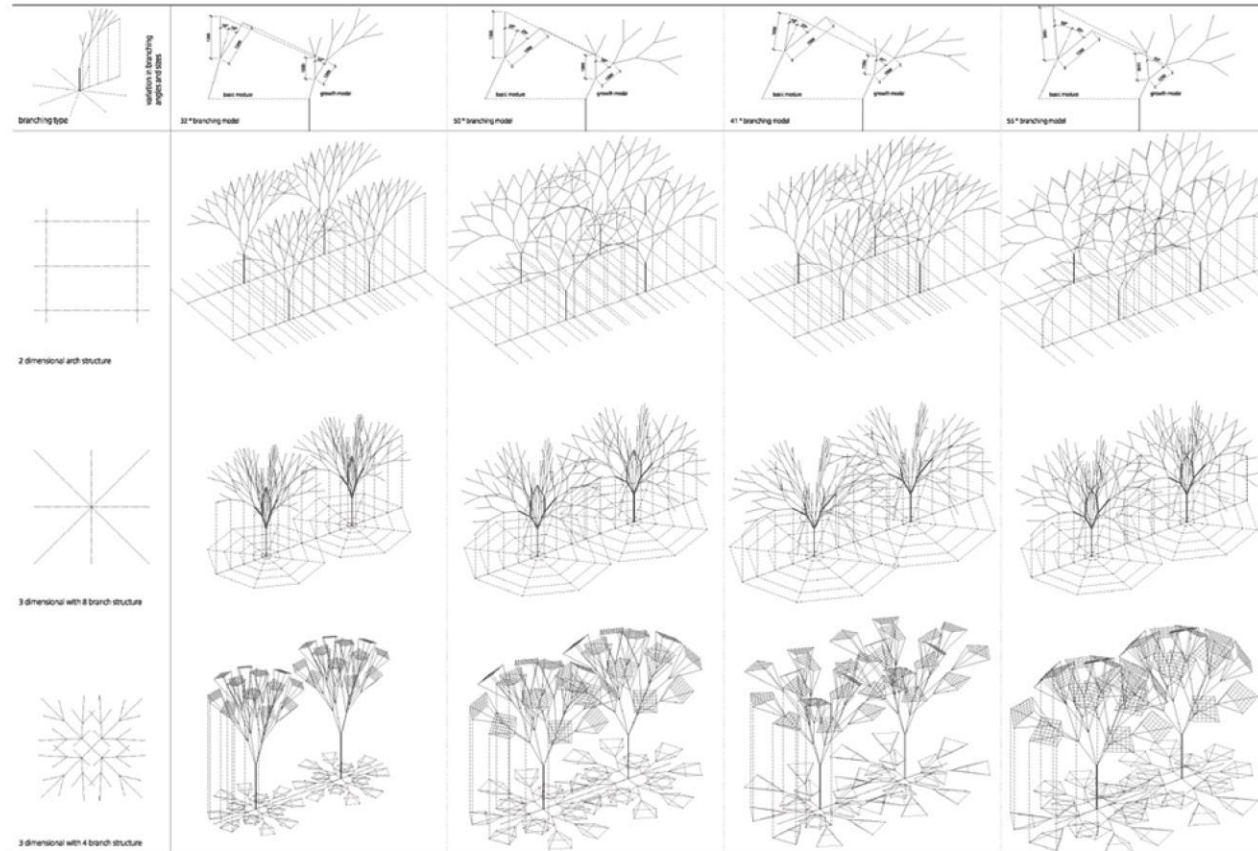
Idea Sketch by Toyo Ito
Sendai z, Japan

Typological Formation



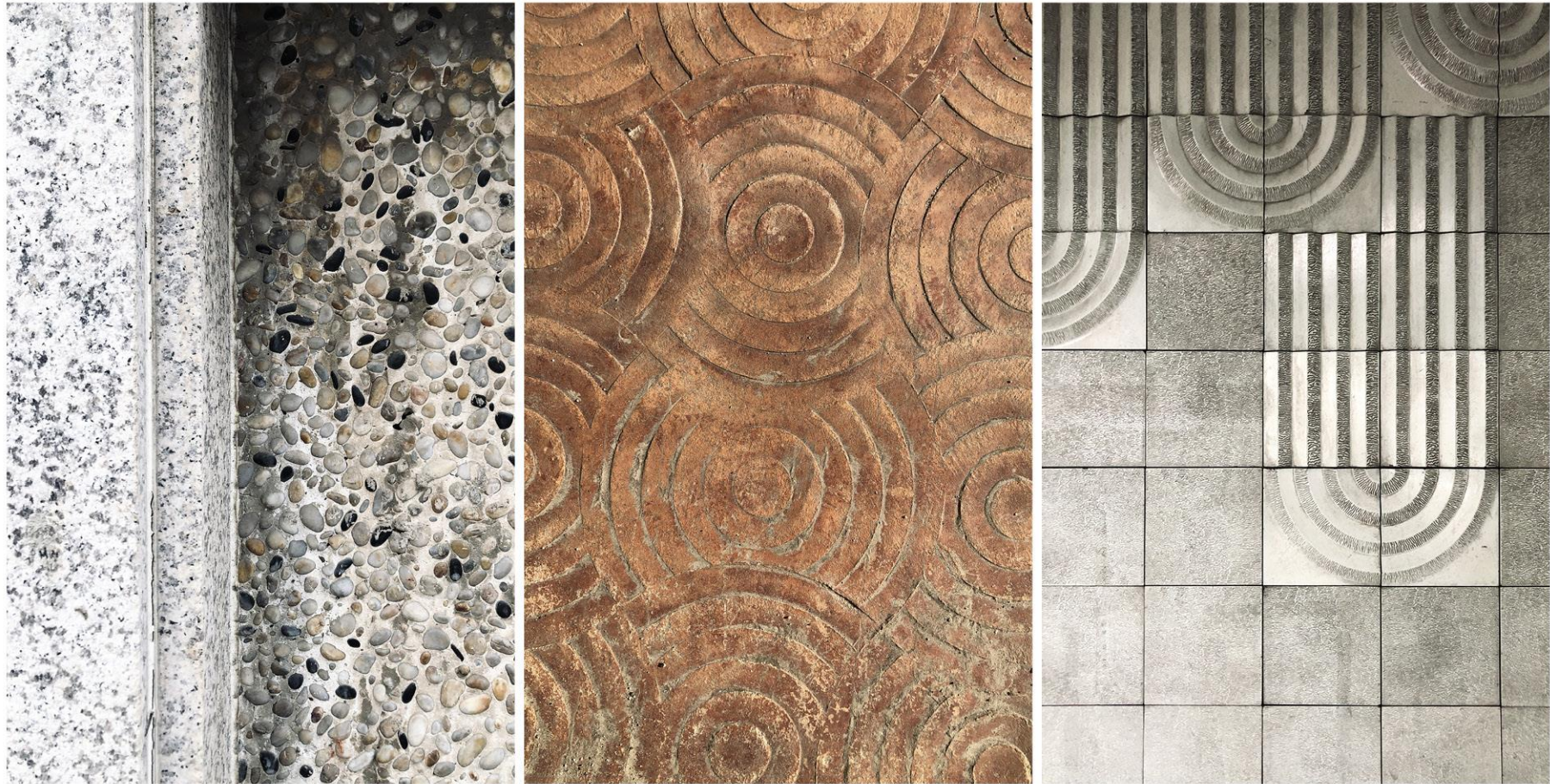
Formation Process Diagrams
Yonsei Architecture, 2023

Typological Formation



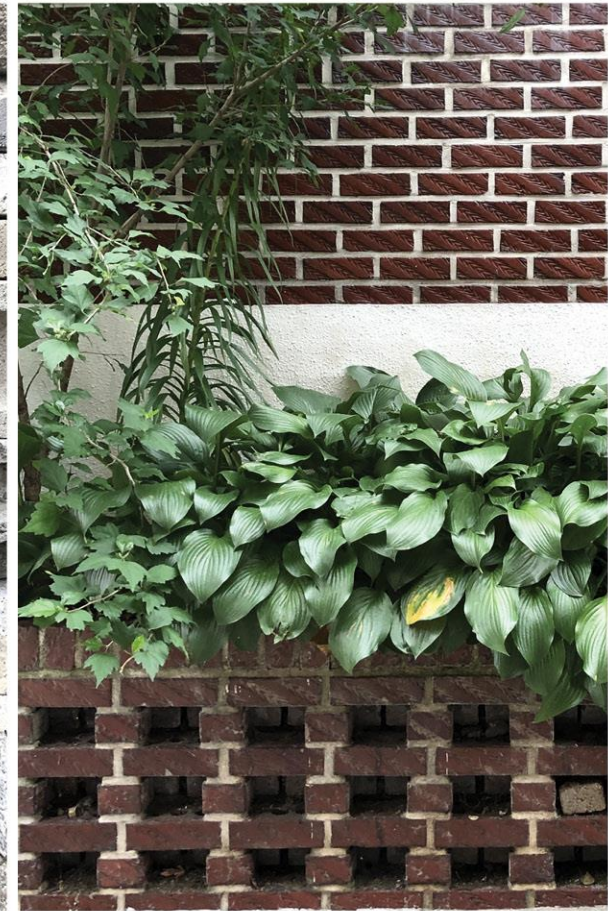
Matrix of differentiation: branch to vaults for The Tote, Mumbai, India 2007-2009
 'Working In Series' by Serie Architects

The Vernacular : Materiality



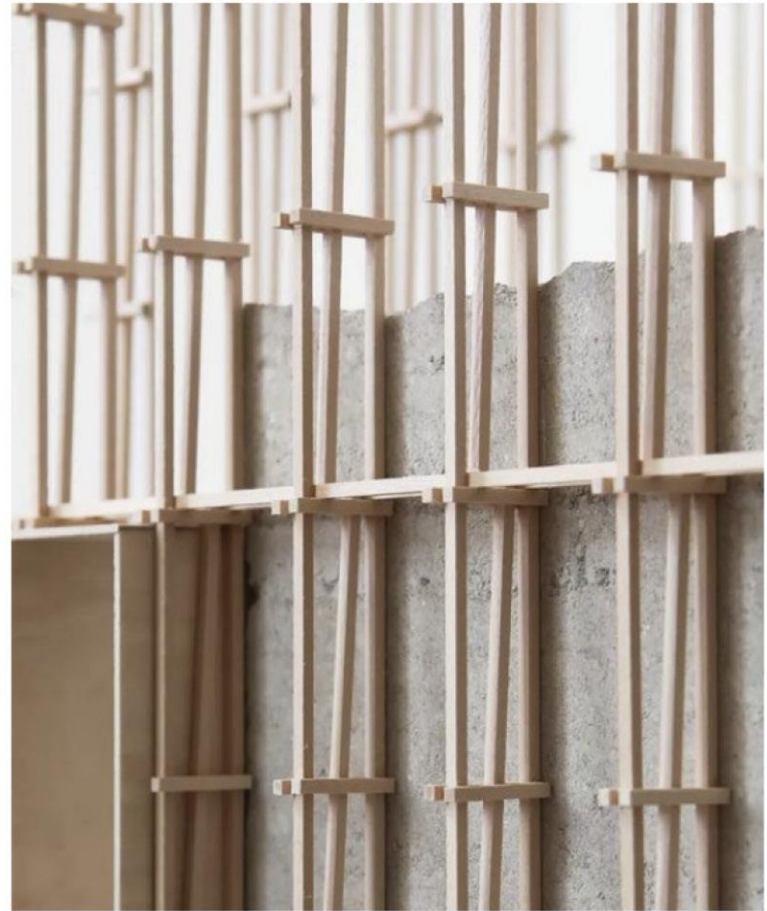
Seongbukgu, Seoul

The Vernacular : Tectonics



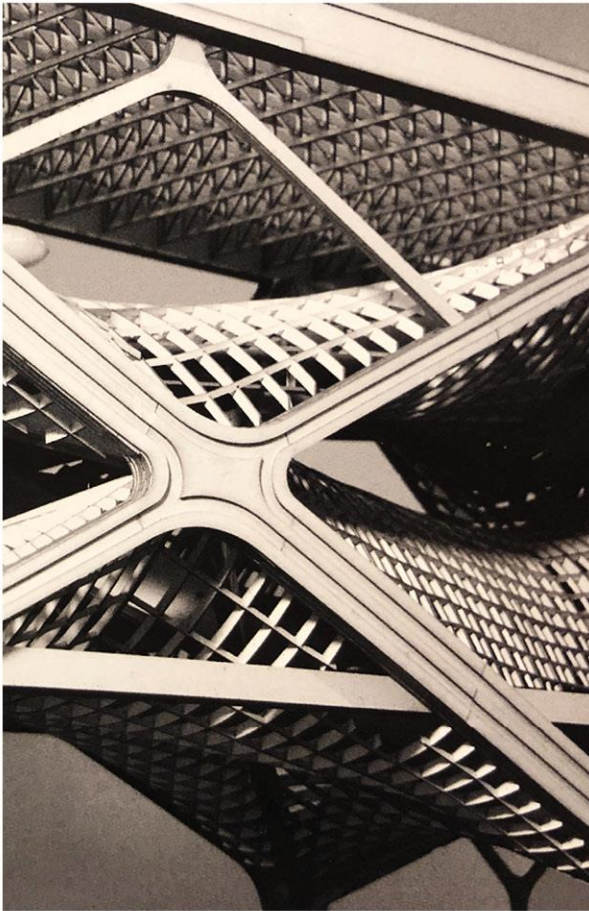
Seongbukgu, Seoul

Materialization : Fragment Models



Model Iterations & Process models as part of research on Danish building culture
Thi & Dencker Arkitekter

Materialization : Fragment Models



Martin Jameson, Fragment Model,
Project Runway, Thames Estuary, UK
Diploma Unit 6, Architectural Association, London 2008



Jeesoon Lim, Fragment Model,
The Capital Airport, Seoul, Korea
Diploma Unit 6, Architectural Association, London 2008



Model for The Tote, Mumbai, India 2007-2009
'Working In Series' by Serie Architects

Idea for the City : Project Your Idea of the City



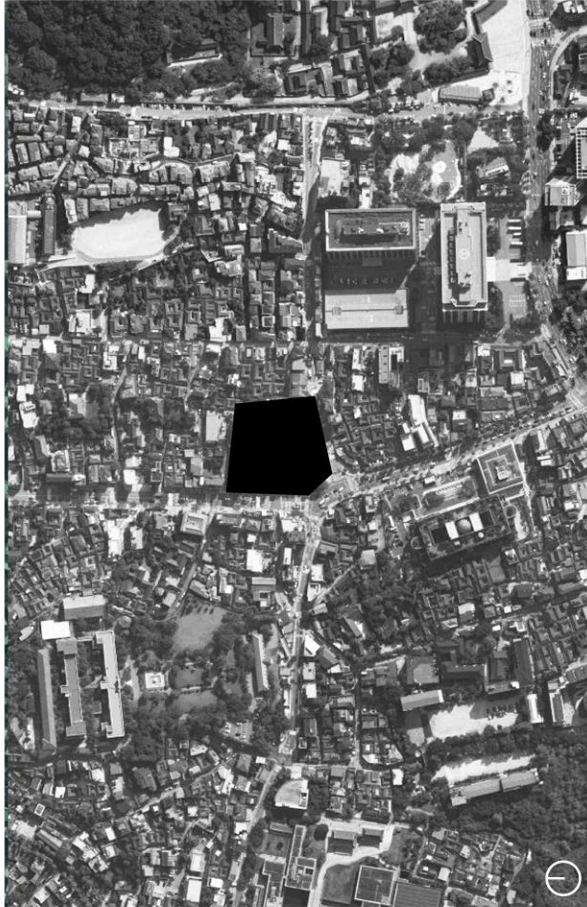
Max von Werz, Urban Plan, Open Source Fabric, Zorrozaurre, Bilbao, Spain
Diploma Unit 6, Architectural Association, London 2007

Idea for the City : Conclusion of Your Project



Udayan Mazumdar, Airport Visualisation, Zero Ground, Mumbai, India
Diploma Unit 6, Architectural Association, London 2008

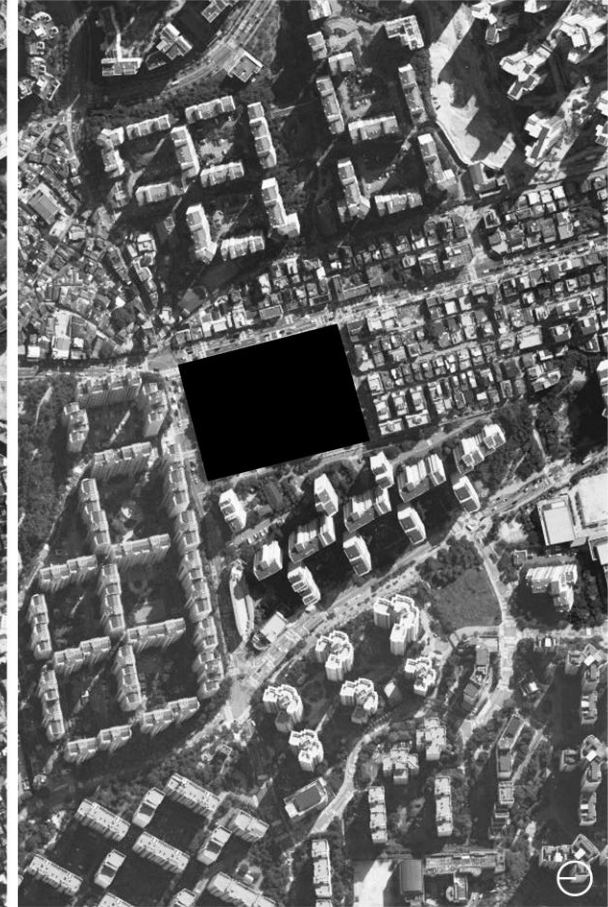
The Sites



Site A : Jaedong Elementary School
Jongro gu, Seoul



Site B : Anam Elementary School
Seongbuk gu, Seoul



Site C : Mia Elementary School
Seongbuk gu, Seoul

Instructor



Jeeseon Lim

Director at Workshop Lim
ARB RIBA
AA Diploma, AA School, London UK
BSc Yonsei University

Prior to establishing Workshop Lim, she gained a wide range of experience at global practices such as FOA, Zaha Hadid Architects and Woods Bagot in London.

She led the design team on various projects as an Associate at Studio Kyson in London.

She has been teaching architectural design studios at Korea University since September 2022 and at Yonsei University since March 2023.

Studio 5

Green Tourism Resort

Instructors

Jae-woo Lee (이재우)

그린투어리즘 리조트

그린투어리즘은 '비일상의 공간'에서 '비일상의 시간'을 보내고, 다시 '일상'으로 돌아오는 '일상과 비일상의 교차점'이다. 자신의 삶과 지역의 지속가능한 발전을 동시에 추구하는 활동이다. 자연이 넘쳐나는 농촌지역에서 전통문화를 체험하고, 사람과 사람간의 교류를 즐기는 체류형 여가활동으로 정의할 수 있다.

여기서 '그린'은 전원(畵)이나 자연만을 의미하지 않는다. '자연과 인간의 조화로운 공존과 자원의 적절한 이용 등 만물의 상생관계에 대한 인식'이라는 '생태철학'과 사회·문화의 지속가능성을 지켜내는 인류학적 의미가 내포되어 있다.

'투어리즘' 역시 단순한 여가활동을 넘어, 다양하고 개성 있는 농촌체험과 사람들 간의 인적 교류를 통해 심신을 회복하는 활동이다. 나아가 도시인은 친환경적인 라이프 스타일로 삶을 바꾸어가고, 도농 교류를 통해 지역과 농촌을 살리는 연대활동이기도 하다. '그린 투어리즘'은 여행 중에 자연보호 활동을 하거나 특정지역의 생태를 관찰하는 등 다양한 유형으로 이루어지며 정부가 추진하고자 하는 농촌 6차산업화의 창조경제의 중심 기능으로 가능 하다. 그린투어리즘은 지나친 환경 개발로 인한 생태 오염과 수입 농산물 개방에 따른 농어촌의 경기침체가 만들어낸 관광업계의 블루오션인 셈이다. 농촌의 자연환경과 전통 문화 등을 매개로 도시와 농촌지역의 교류를 확대하기 위한 친환경적 관광 사업이다

Green Tourism Resort

Green tourism is the 'intersection of the ordinary and the non-daily' where one spends 'extraordinary time' in an 'extraordinary space' and then returns to 'daily life'. It is an activity that simultaneously pursues the sustainable development of one's own life and the region. It can be defined as a sojourn-type leisure activity where you can experience traditional culture in a rural area overflowing with nature and enjoy human-to-human exchanges.

Here, 'green' does not mean just rural (forest) or nature. It contains the anthropological meaning of preserving the sustainability of society and culture and the 'ecological philosophy' of 'recognition of the mutually beneficial relationship of all things, such as the harmonious coexistence of nature and humans and the proper use of resources'.

'Tourism' is also an activity that goes beyond simple leisure activities to restore the mind and body through diverse and unique rural experiences and human exchanges between people. Furthermore, it is also a solidarity activity for urban residents to change their lives with an eco-friendly lifestyle and to save the region and rural areas through urban-rural exchanges. 'Green tourism' consists of various types such as nature conservation activities during travel or observation of the ecology of a specific area, and it is possible as a central function of the creative economy of the 6th industrialization of rural areas that the government seeks to promote. Green tourism is a blue ocean in the tourism industry created by ecological pollution caused by excessive environmental development and economic downturn in rural areas following the opening of imported agricultural products. It is an eco-friendly tourism project to expand exchanges between cities and rural areas through the natural environment and traditional culture of rural areas.



가볼만한 주요 수목원



아기자기하고 예쁜 정원 분위기 아침고요수목원

위 치 / 경기 가평군 상면 수목원로 432

개장일 / 1996년 5월

이용시간 / 08:30~일몰시

오색별빛정원전 09:00~17:00

※폐장 1시간 전까지 입장 가능

홈페이지 / www.morningcalm.co.kr

아침고요수목원은 축령산의 빼어난 자연경관을 배경으로 하여 한국의 미를 듬뿍 담은 정원들을 **원예학적으로 조화시켜 설계한 원예수목원**이다. 20개의 주제를 가진 정원은 아름답게 가꾸어진 잔디밭과 화단, 자연스러운 산책로로 연결돼 있다. 특히 아름다운 대한민국의 금수강산을 실제 한반도지형 모양으로 조성하여 최고 절정의 꽃으로 표현한 하경정원(Sunken Garden)은 관광객들의 관심을 가장 많이 끄는 곳이다. 또한 이곳에는 백두산 식물 300여종을 포함한 5,000여종의 식물들을 만날 수 있으며, 영화 "편지"의 촬영장소로 알려져 많은 관광객들이 다녀가고 있다.











지域경제 활성화 · 부가가치 증대 · 공동체 회복 및 생산적 복지

||



농산물 생산
특산물 생산
기타 유 무형 자원

×



식품 제조 가공
특산물 제조 가공
공산품 제조 등

×



유통 판매,
체험 관광 축제
외식 숙박 컨벤션
치유 교육 등

자연 자원
보전



관광객



지역사회



경제적
이익



세명의 운영자인 와인메이커(Winemaker), 핏마스터(Pit master), 가드너(Gardener)의 개별 매장 및 각각 면적 230 m² (약 70평) 미만의 농가민박주택을 설계한다.

서로의 독립성을 유지하는 동시에 협업하여 경제적 이익을 공유할 수 있다.

세명이 한 팀으로 마스터플랜과 공동 운영 계획을 수립하고, 중간평가 이후에는 각자 세명의 매장과 주택을 나누어 디자인 한다.

목수 Carpenter, 바리스타, Baker, Brewer, Librarian, 등 각자 선호하는 테마 인원을 보충, 또는 교체 할 수 있다.

There are three main operators for this project, Winemaker, Pit master and Gardener

Design three individual stores and farmhouses with an area of less than 230 m² (about 70 pyeong) each.

While maintaining each other's independence, they can collaborate and share economic benefits.

As a team of three, they establish a master plan and a joint operation plan, and after the midterm evaluation, each of the three stores and houses are designed separately.

Carpenter Carpenter, Barista, Baker, Brewer, Librarian, etc., can be supplemented or replaced with the theme of each person's preference.











